

COMPONENT LIST	
QTY	NAME
1	WAVEGUIDE
2	U BOLT
1	N CONNECTOR
2	WAVEGUIDE END PLATE

Two endplates are needed.
One for each end of the waveguide.

Tap these holes with
closest standard threads.

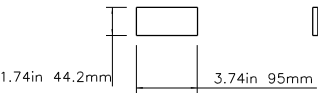
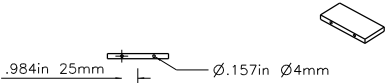

REV	DESCRIPTION	BY	DATE
TITLE			
32 Slot Waveguide			
SCALE		DATE	
DRAWN BY			
CHECKED BY			
APPROVED BY			
PROJECT NUMBER		DRAWING NUMBER	

2" x 4" rectangular aluminum extrusion
approximately 1/8" thick walls (3.1mm)

Note:
Inside Dimensions Tolerance: 0.5%

Machine bolt holes with closest matching tap.
Standard machine screws should fit hole threads.
Large N connector hole does not need threads.